



Belsize Grove NW3

Parkheath  
*Sold on Service*





## Belsize Grove, NW3, Asking Price £490,000, Share of Freehold

### Camden Band D

- A well presented, impressive 1 bedroom apartment
- Set in a popular purpose built block
- Lift and portorage
- Views overlooking the well maintained communal gardens
- Approaching 450 sq ft on the 2nd floor
- 17ft reception
- 11ft bedroom with built-in wardrobes
- Separate 9ft kitchen
- Share of freehold
- Moments to all Belsize Park amenities



Belsize Park/Hampstead  
208 Haverstock Hill  
NW3 2AG  
Sales 020 7431 1234  
Lettings 020 7431 3104  
[nw3@parkheath.com](mailto:nw3@parkheath.com)

South/West Hampstead  
192 West End Lane  
NW6 1SG  
Sales & Lettings  
Tel 020 7794 7111  
[192@parkheath.com](mailto:192@parkheath.com)

Kensal Rise  
54-56 Chamberlayne Rd  
NW10 3JH  
Tel 020 8960 4845  
[kensal@parkheath.com](mailto:kensal@parkheath.com)

Property Management  
192 West End Lane  
NW6 1SG  
020 7433 6174  
[pm@parkheath.com](mailto:pm@parkheath.com)

[www.parkheath.com](http://www.parkheath.com)

**Parkheath**  
*Sold on Service*

Holmefield Court,  
Belsize Grove, NW3  
Approx. Gross Internal Area  
443 Sq Ft - 41.15 Sq M

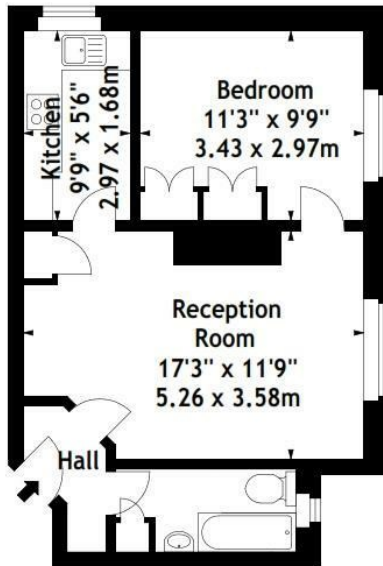

Second Floor

Measured in accordance with RICS guidelines. Every attempt is made to ensure accuracy, however all measurements are approximate. This floor plan is for illustrative purposes only and is not to scale.  
© Datography Ltd 2016  
Photographs \* Floorplans \* Virtual Tours  
Tel: 0845 643 4401 www.datography.com

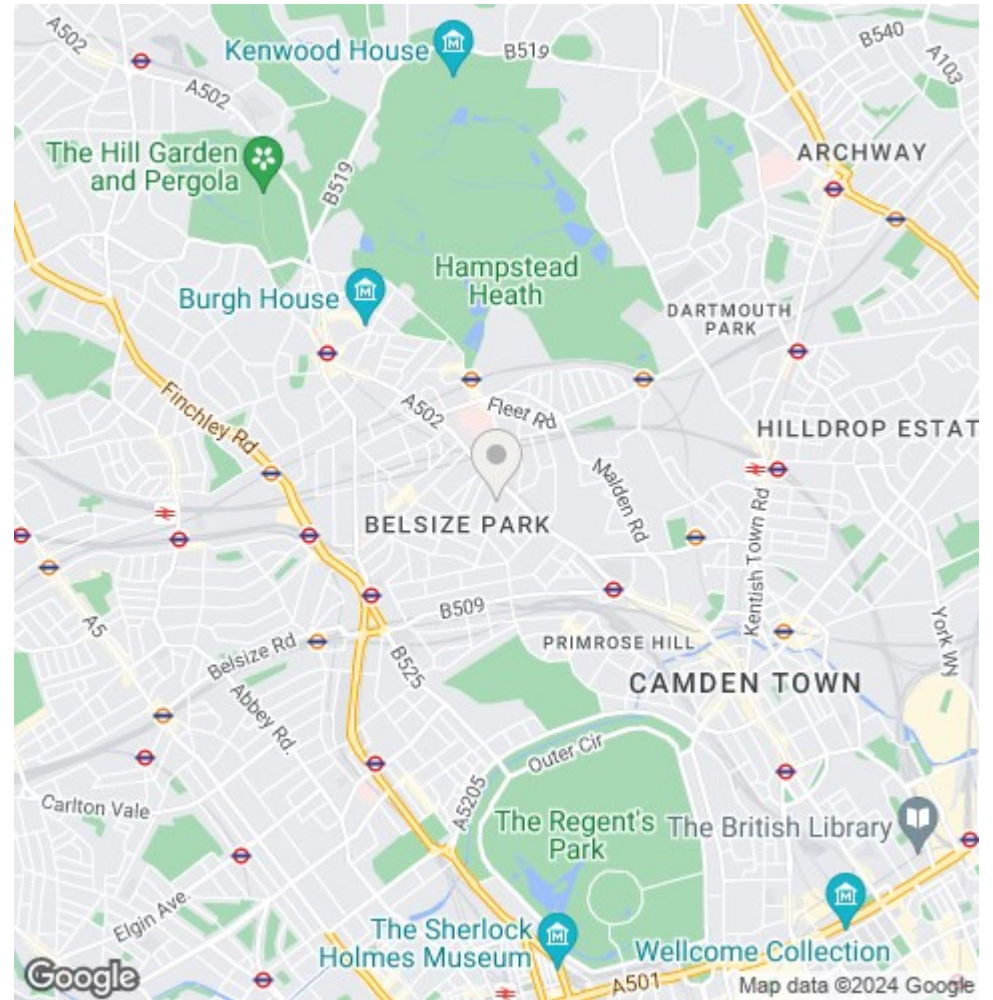

The particulars do not constitute part of an offer or contract. The particulars, including text, photographs and plans, are for the guidance only of prospective purchasers/tenants and must not be relied upon as statements of fact. The descriptions provided therein represent the opinion of the author and whilst given in good faith should not be construed as statements of fact. Nothing in these particulars shall be deemed a statement that the property is in good condition or otherwise or that any services or facilities are in good working order. All measurements are approximate